



## ***RK35***

### **REEL KLEEN RK35**

### **INSTALLATION, OPERATING AND MAINTENANCE MANUAL**

**PLEASE LEAVE WITH OPERATOR**

## INDEX

<b>EC DECLARATION OF CONFORMITY.....</b>	<b>3</b>
<b>GUARANTEE.....</b>	<b>4</b>
<b>WATER SUPPLY.....</b>	<b>4</b>
<b>COMMISSIONING .....</b>	<b>4</b>
<b>MAINTENANCE .....</b>	<b>4</b>
<b>MATERIAL CONTENT.....</b>	<b>4</b>
<b>EXPLODED VIEW .....</b>	<b>5</b>
<b>CONTACT DETAILS .....</b>	<b>6</b>

## EC DECLARATION OF CONFORMITY

### EC DECLARATION OF CONFORMITY

(Guarantee of Production Quality)

We, Imperial Machine Company Limited of:  
Unit 1, Abbey Road, Wrexham Industrial Estate, Wrexham, LL13  
9RF

Declare under our sole responsibility that the machine



### REEL KLEEN RK35

As described in the attached technical documentation is in conformity with the Machine Safety Directive 89/392/EEC as amended by 91/368/EEC and 93/44/EEC and is manufactured under a quality system BS EN ISO 9001. It is also in conformity with the protection requirements of the Electro Magnetic Compatibility Directive 89/336/EEC and is manufactured in accordance with harmonised standards EN 55014-1 Emission and EN 55014-2 Immunity (plus product specific standards).

Approved by E Plumb, Engineering Manager

A handwritten signature in black ink, appearing to read 'E Plumb', is written over a light grey background.

Signed at Wrexham, Date

September 2017

## GUARANTEE

This equipment is guaranteed by IMC for 1 year from the date of its purchase from IMC, or from one of its stockists, dealers or distributors. The guarantee is limited to the replacement of faulty parts or products and excludes any consequential loss or expense incurred by purchasers. Defects that arise from faulty installation, inadequate maintenance, incorrect use or fair wear and tear are not covered by the guarantee.

The guarantee applies in this form to installations within the United Kingdom.

## WATER SUPPLY

**NOTE:** These units are designed to be fitted to a mains water supply in accordance to local water board regulations. This applies to UK installations; overseas customers should install the machine in accordance with local regulations.

**IF IN DOUBT, CHECK WITH YOUR LOCAL AUTHORITY**

## COMMISSIONING

These instructions are designed to aid you in the installation of the REEL KLEEN.

1. All REEL KLEEN's come with Hose, they are set at the proper tension and are ready for wall mounting.
2. The REEL KLEEN can also be mounted from the floor or ceiling.
3. When floor or ceiling mounted, the hose guide should be adjusted to allow the hose to be pulled from the REEL KLEEN in a straight line for maximum hose life.
4. A 3/4" BSP flexible connection is supplied for connection to the water inlet.
5. Connect water supply line and tighten with a Spanner.
6. Turn on water supply and check for leaks.

## MAINTENANCE

Other than regular cleaning the REEL KLEEN's require no maintenance by the end user.

## MATERIAL CONTENT

The REEL KLEEN contains the following materials:

Metals	Stainless steel, Mild steel (inc plated).
Plastics and rubber	Neoprene rubber.

EXPLODED VIEW

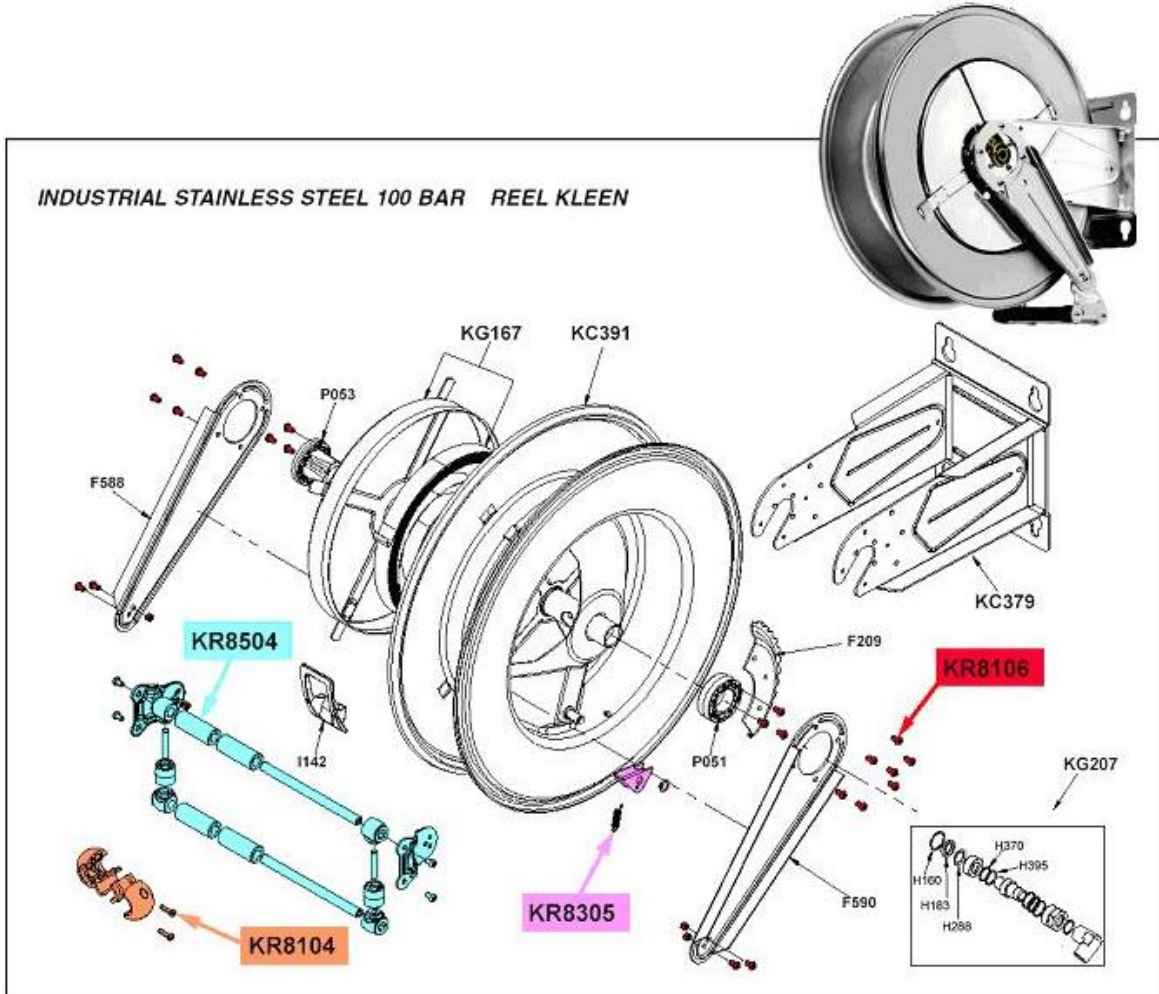

SPARE PARTS GUIDE

**SPARE PARTS KITS**  
EACH KIT SHOWN WITH THE SAME COLOUR INCLUDES ALSO THE GASKETS, THE SPARE PARTS COMPOSING THE KIT CAN'T BE SUPPLIED SEPARATELY EXCEPT THOSE SHOWN WITH A PROPER CODE.

CODE	DESCRIPTION	Q.TY
KR8104	HOSE STOP FOR HOSE REEL	1
KR8106	SET OF SCREWS H REEL	1
KR8305	DETENT	1
KR8504	ROLLERS HOLDING KIT FOR 430 H REEL	1

LIST OF SPARE PARTS WHICH CAN BE SUPPLIED SEPARATELY

CODE	DESCRIPTION	Q.TY
F209	RACK	1
F588	SWINGING ARM	1
F590	SWINGING ARM	1
H370	O-RING 2062 "VITON"	1
H160	O-RING 2093	1
H183	GASKET	1
H288	WASHER	1
I142	ROSE/OUTLET PROTECTION	1
KC379	BRACKET	1
KC391	DRUM 430	1
KG167	COVER-SPRING GROUP	1
KG207	JOINT	1
P051	BUSH	1
P053	BUSH	1
V591/ECO	INSTRUCTION MANUAL	1

ART. **KS7188** SPARE PARTS KIT ADVISED TO THE SELLING CENTERS. THIS KIT INCLUDES ALL THE SPARE PARTS SHOWN HERE UNDER.

CODE	DESCRIPTION	Q.TY
H370	O-RING 2062 "VITON"	1
H160	O-RING 2093	1
H183	GASKET	1
H288	WASHER	1
H395	WASHER PTFE	1
KG207	JOINT	1

## CONTACT DETAILS

For installations outside the UK please contact your supplier.

For information on IMC service support (if applicable), please call IMC on +44 (0) 1978 661155. Alternatively, contact us via email or fax:

IMC Spares Desk

Fax: +44 (0) 1978 667759

E-mail: [spares@imco.co.uk](mailto:spares@imco.co.uk)

IMC Service Desk

Fax: +44 (0) 1978 667766

E-mail: [service@imco.co.uk](mailto:service@imco.co.uk)

Imperial Machine Company Limited  
Unit 1, Abbey Road  
Wrexham Industrial Estate  
Wrexham LL13 9RF

Tel: +44 (0)1978 661155

Fax: +44 (0)1978 729990

E-mail: [info@imco.co.uk](mailto:info@imco.co.uk)

Website: [www.imco.co.uk](http://www.imco.co.uk)